

Usability has also been upgraded. More speed, more stroke, more capacity

Demonstration Workpieces

CONNECTOR VALVE

LFV mode 1

Breaking up of chips (Outer-diameter)
 >> Turning process
 >> Grooving process
 >> Cut-off

Cross-hole Chamfering

Using 3D chamfering

LFV mode 1

Breaking up of chips (Inner-diameter)
 >> drilling process
 >> Boring process

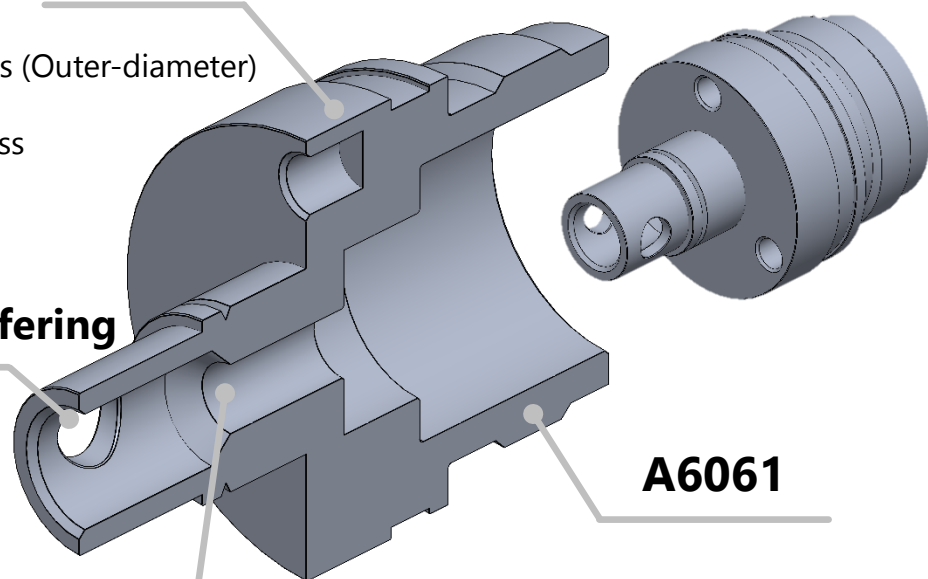

A6061

* LFV mode-1 covers almost all machining processes.

Highlight machine

LFV (Low frequency vibration)

The servo axes are vibrated in the axial direction using a unique control technology where by cutting is performed while synchronizing this vibration with the rotation of the spindle

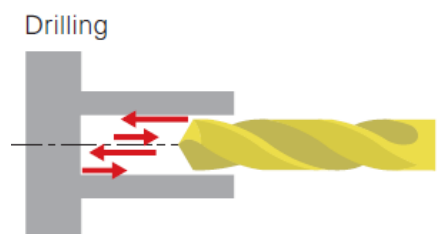
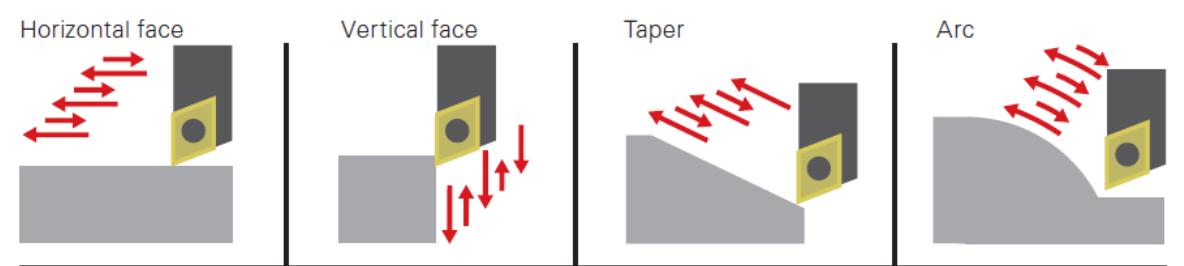

Mode 1: Turning and drilling

Define the number of vibrations per workpiece rotation

Machine Specification

- ✓ Main spindle (Max 20(25)mm Dia./ 10,000 RPM)
- ✓ Back spindle (Max 20(25)mm Dia./ 8,000 RPM)
- ✓ Turning tool
- ✓ Rotary tool (Cross, End-face)
- ✓ Simultaneous machining 4 axis (X,Y,Z,C)

Main Machine Configuration

